



Vertex Double Action Ankle Joint



Double Action Thermoplastic Ankle Joint

Why the Vertex Double Action?

- True Thermoplastic Double Action Ankle Joint
- Allows Precise Degree Fine Tuning with Spring Assist/Resist
- Sleek Low Profile Design
- Infinite Degree Setting within 60 Degree Dorsi/Plantar Range
- Ability to lock in any degree of dorsi/plantar flexion
- Pro-Contoured Proximal and Distal Uprights
- Recessed, Countersunk Bushing and Screw Midsection sets flush on medial and lateral surface, providing a slim line non-protrusion surface
- Threaded Attachment Holes
- Provides Superior Medial and Lateral Control
- Provides Superior Torsional Stability/Control of AFO
- Fully Machined Durable Stainless Steel Construction
- Light Weight
- Ease of Fabrication
- Affordable, Adjustable, Convenient
- Extremely Cost Effective!



**Adult Vertex
Double Action**



**Pre- Contoured
Uprights**



**Screw & Bushing
Midsection Design**



www.certifiedortho.com



1 (800) 466-7015



Vertex Double Action Ankle Joint

Vertex Double Action Dimensions

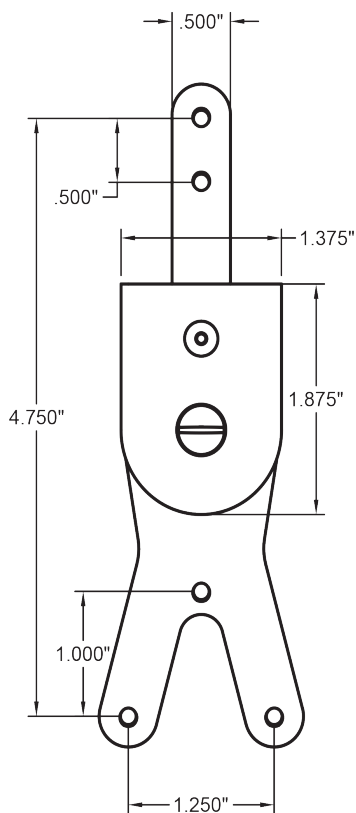

Ordering Information

Vertex Double Action Ankle Joint

Product#	Description	Size	Unit
VX-220A	Vertex Double Action Ankle Joint	Adult	Pair

***Vertex Double Action Ankle Joint Includes:**

- 1 Pair Vertex Double Action Ankle Joints, Attachment Screws,
- 1 Pair Ankle Joint Pads

Pin Stop



Product#	Description	Size	Unit
VX-220A-#4	Vertex Double Action Pin Stop	Adult	Each

***Pin Stops can be utilized in both channels to completely lock out joint. Pin stops can also be utilized in posterior/anterior channel to block dorsi or plantar flexion**

Dorsi-Only Spring and Pin Kit



Product#	Description	Size	Unit
VX-220A-DAS	Vertex Dorsi-Only Spring Kit	Adult	Pair

***The Dorsi-Only spring kit provides a longer spring and pin if dorsi-assist only is desired. The longer spring increases the dorsi angle and provides increased dorsi-assist.**

Fabrication Kit

Product#	Description	Size	Unit
VX-220A-KIT	Vertex Double Action Fab. Kit	Adult	Pair

***Vertex Fabrication Kit Includes:**

- 1 Pair Vertex Spacer Pads, Threaded Rod,
- Hex Nuts, Fabricating Nails

